

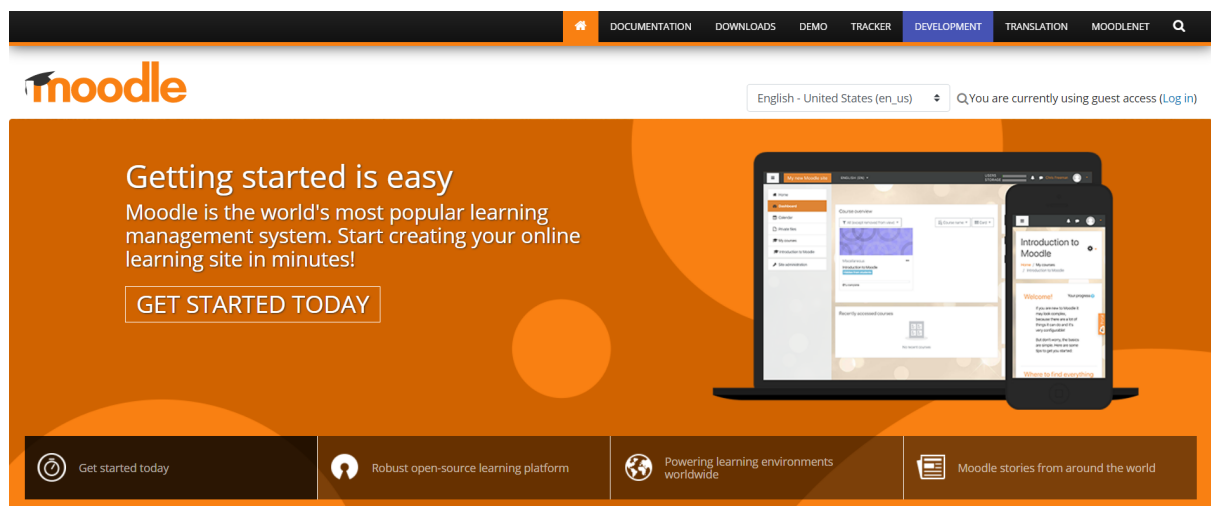

STEP BY STEP GUIDE INSTALLING MOODLE MOBILE ON YOUR SMART-PHONE FOR E-LEARNING

<https://moodle.org/> and <https://moodle.com/>



Created by:

Noor Syarifuddin Bin Muharam

Ts. Ahmad Shaarizan Shaarani



1. What is Moodle?

Moodle is a learning platform designed to provide educators, administrators and learners with a **single robust, secure and integrated system** to create personalised learning environments. You can download the software onto your own web server.

- ❖ Moodle is built by the Moodle project which is led and coordinated by Moodle HQ, which is financially supported by a network of over 80 Moodle Partner service companies worldwide.
- ❖ Moodle was developed by Martin Dougiamas, who grew up in the Australian outback in the late 1970s. Dougiamas was educated via the School of the Air— correspondence schools in the remote areas of Australia whose curriculum was largely delivered by radio, indoctrinating him in distance learning at an early age.
- ❖ Today, Moodle is used by organizations of all shapes and sizes outside of the education community. Most commonly, Moodle is used by businesses, corporations, hospitals and non-profits for training, online learning and in some cases it is used for extended business processes.

Source: https://docs.moodle.org/38/en/About_Moodle
<https://www.lambdasolutions.net/guides-and-research/moodle-user-guide-intro-to-moodle>

2. Why use Moodle?



- ❖ **Proven and trusted worldwide** – Powering tens of thousands of learning environments globally, Moodle is trusted by institutions and organisations large and small, including Shell, London School of Economics, State University of New York, Microsoft and the Open University. Moodle's worldwide numbers of more than 90 million users across both academic and enterprise level usage makes it the world's most widely used learning platform.
- ❖ **Easy to use** – A simple interface, drag-and-drop features, and well-documented resources along with ongoing usability improvements make Moodle easy to learn and use.
- ❖ **Free with no licensing fees** – Moodle is provided freely as Open Source software, under the GNU General Public License. Anyone can adapt, extend or modify Moodle for both commercial and non-commercial projects without any licensing fees and benefit from the cost-efficiencies, flexibility and other advantages of using Moodle.
- ❖ **Always up-to-date** – The Moodle project's open-source approach means that Moodle is continually being reviewed and improved on to suit the current and evolving needs of its users.
- ❖ **Moodle in your language** – Moodle's multilingual capabilities ensure there are no linguistic limitations to learning online. The Moodle community has begun translating Moodle into more than 120 languages (and counting) so users can easily localize their Moodle site, along with plenty of resources, support and community discussions available in various languages.

- ❖ **All-in-one learning platform** – Moodle provides the most flexible tool-set to support both blended learning and 100% online courses. Configure Moodle by enabling or disabling core features, and easily integrate everything needed for a course using its complete range of built-in features, including external collaborative tools such as forums, wikis, chats and blogs.
- ❖ **Highly flexible and fully customizable** – Because it is open-source, Moodle can be customised in any way and tailored to individual needs. Its modular set up and interoperable design allows developers to create plugins and integrate external applications to achieve specific functionalities. Extend what Moodle does by using freely available plugins and add-ons - the possibilities are endless!
- ❖ **Scalable to any size** – From a few students to millions of users, Moodle can be scaled to support the needs of both small classes and large organizations. Because of its flexibility and scalability, Moodle has been adapted for use across education, business, non-profit, government, and community contexts.
- ❖ **Robust, secure and private** - Committed to safeguarding data security and user privacy, security controls are constantly being updated and implemented in Moodle development processes and software to protect against unauthorised access, data loss and misuse. Moodle can be easily deployed on a private secure cloud or server for complete control.
- ❖ **Use anytime, anywhere, on any device** - Moodle is web-based and so can be accessed from anywhere in the world. With a default mobile-compatible interface and cross-browser compatibility, content on the Moodle platform is easily accessible and consistent across different web browsers and devices.

- ❖ **Extensive resources available** - Access extensive Moodle documentation and user forums in multiple languages, free content and courses shared by Moodle users across the world, as well as hundreds of plugins contributed by a large global community.
- ❖ **Backed by a strong community** - The Moodle project is well-supported by an active international community, a team of dedicated full-time developers and a network of certified Moodle Partners. Driven by open collaboration and great community support, the project continues to achieve rapid bug fixes and improvements, with major new releases every six months. Come moodle with us in our community forums!

Source: https://docs.moodle.org/38/en/About_Moodle#Always_up-to-date

3. How to use Moodle?

STEP 1

Proceed to Google Apps Store or Apple App Store.

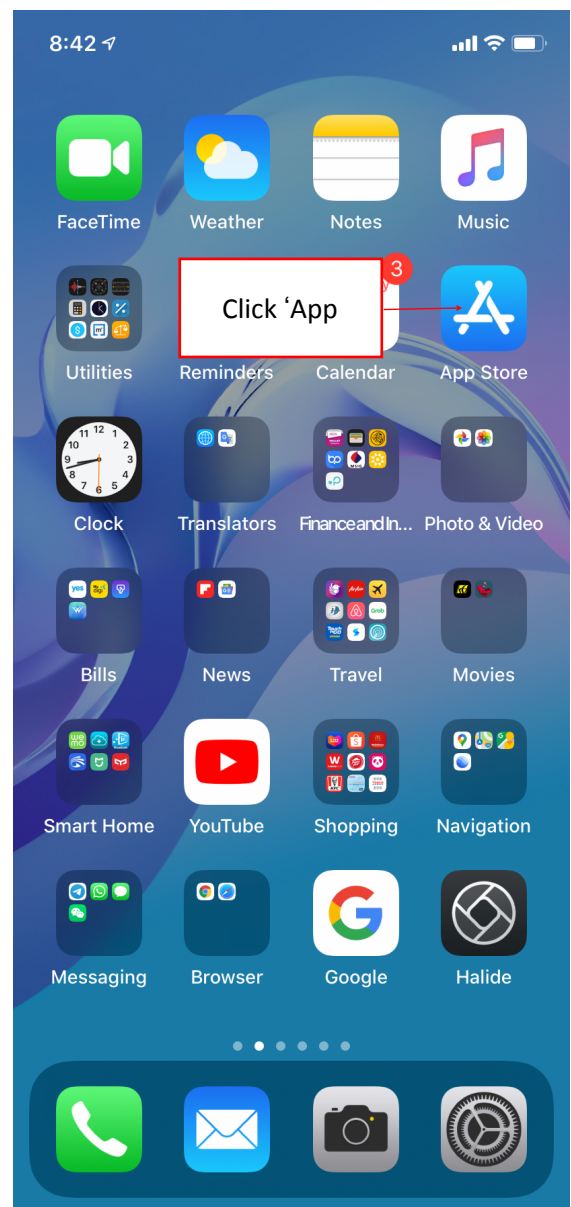

STEP 2

Type the keyword 'Moodle' on the Search function

Type 'Moodle' here.

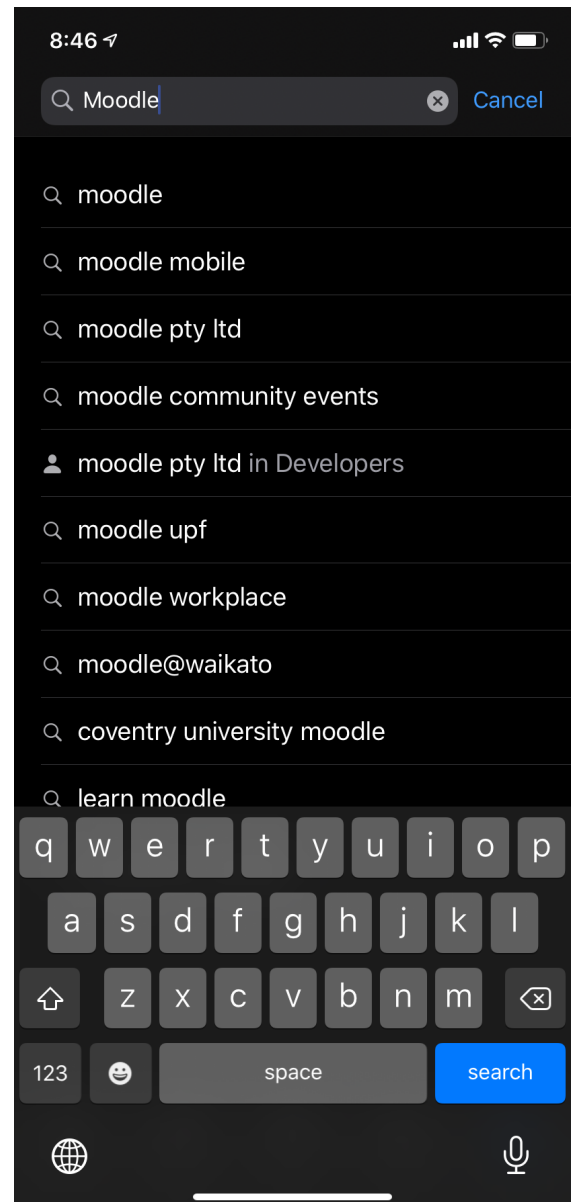
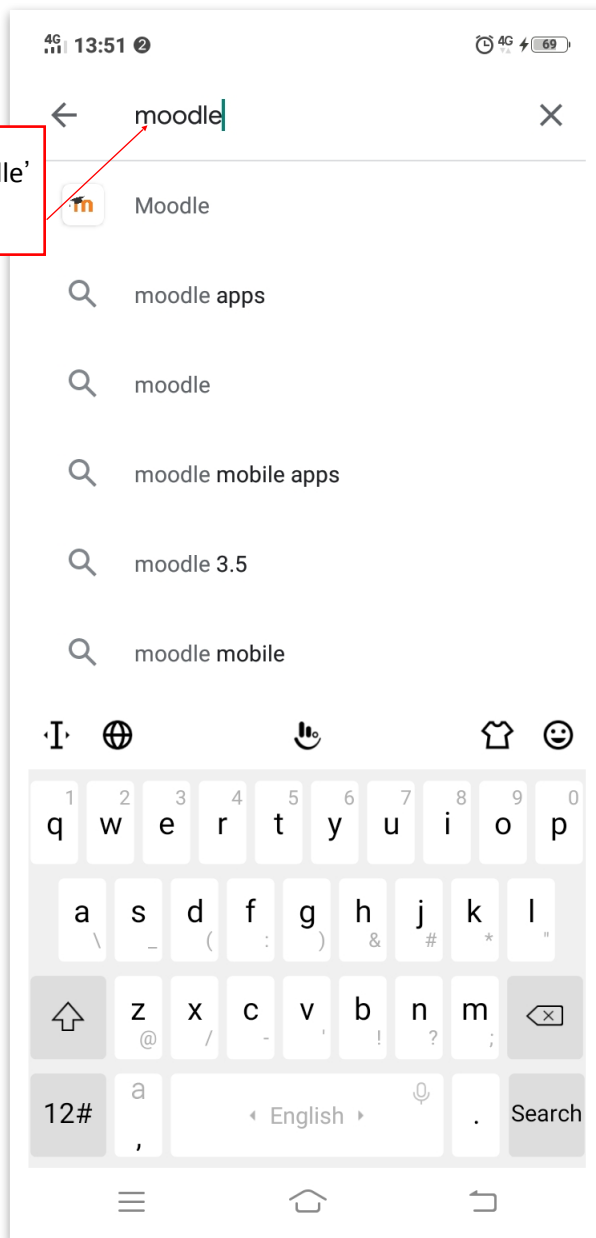

STEP 3

Install the Moodle application.

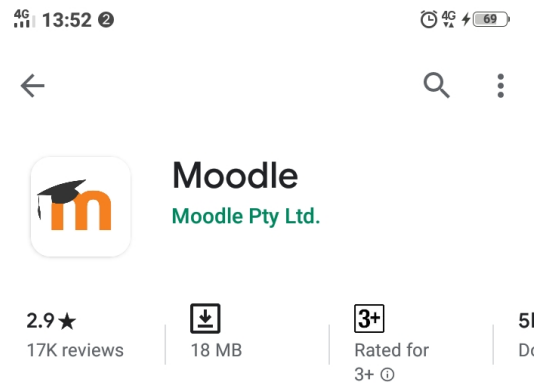

Click on 'In-stall' button.

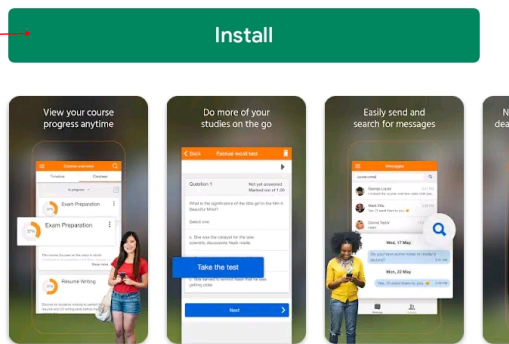

About this app

Improve how you access your Moodle courses with this official helper app

Education

#8 Top free

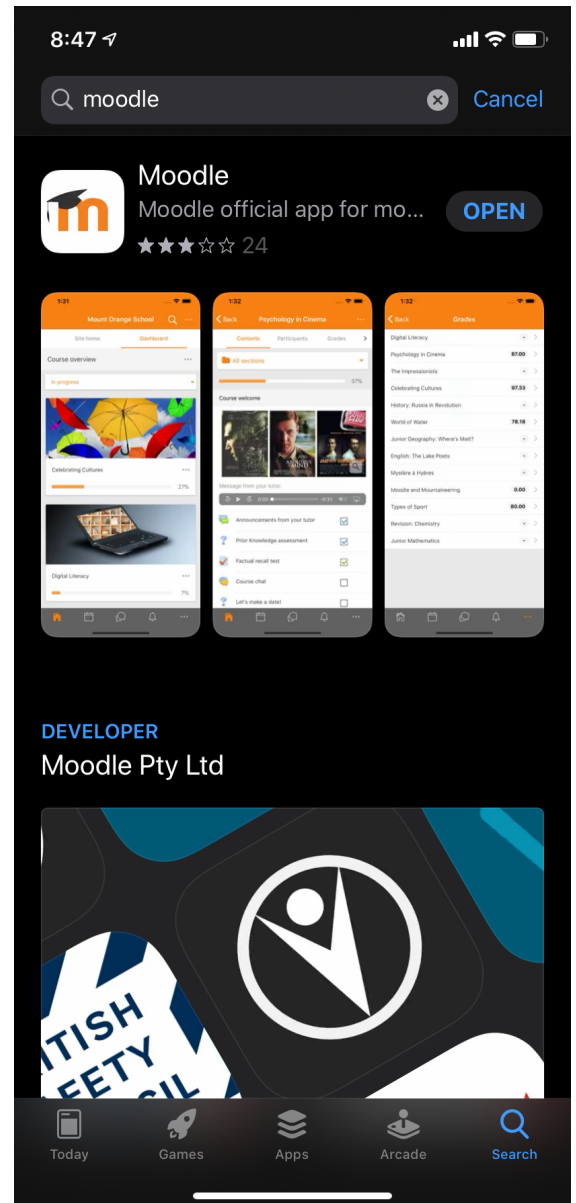

STEP 4

After installing Moodle, proceed to open the application



STEP 5

Connecting the U-Learn into the Moodle Server

In order to connect the U-Learn account into the Moodle Server, you need to insert the U-Learn URL address for the **CURRENT** semester and click 'Connect!' button.

Please insert the URL: <https://ulearn.utem.edu.my/sem2201920/>

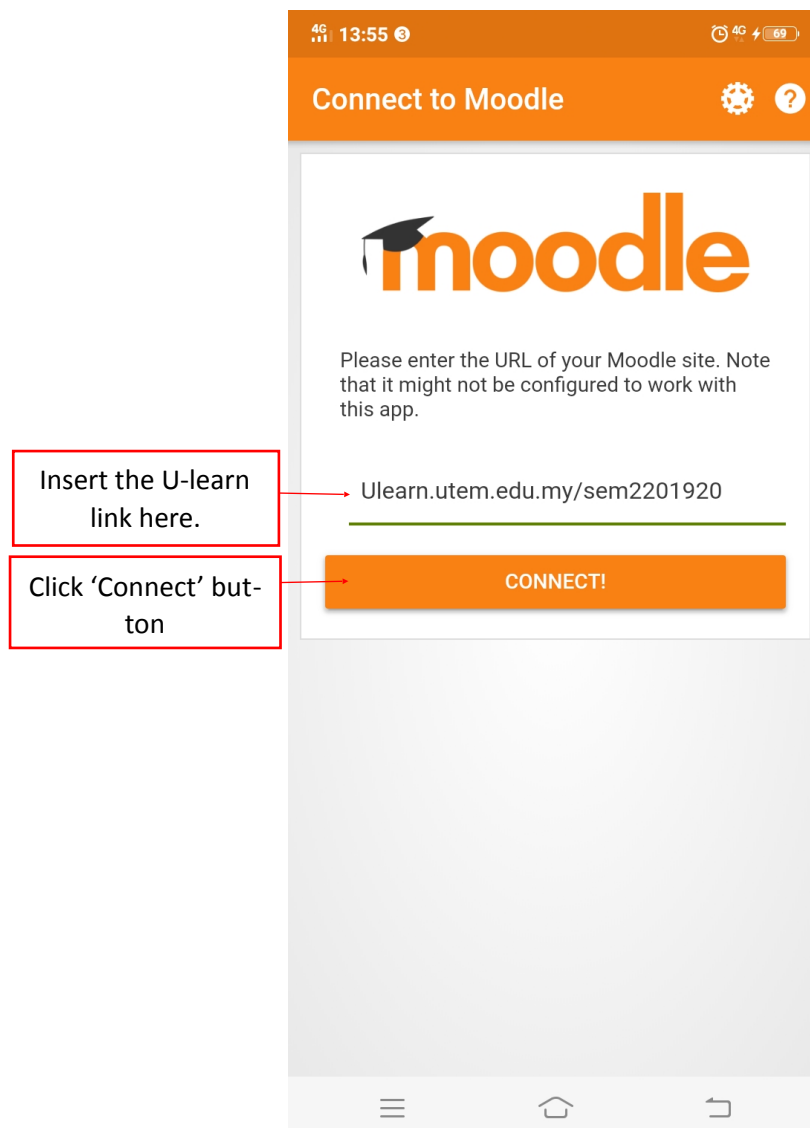

STEP 6

You will be redirected into U-Learn Login. Proceed to log in by using your UTeM's Office 365 email credentials.

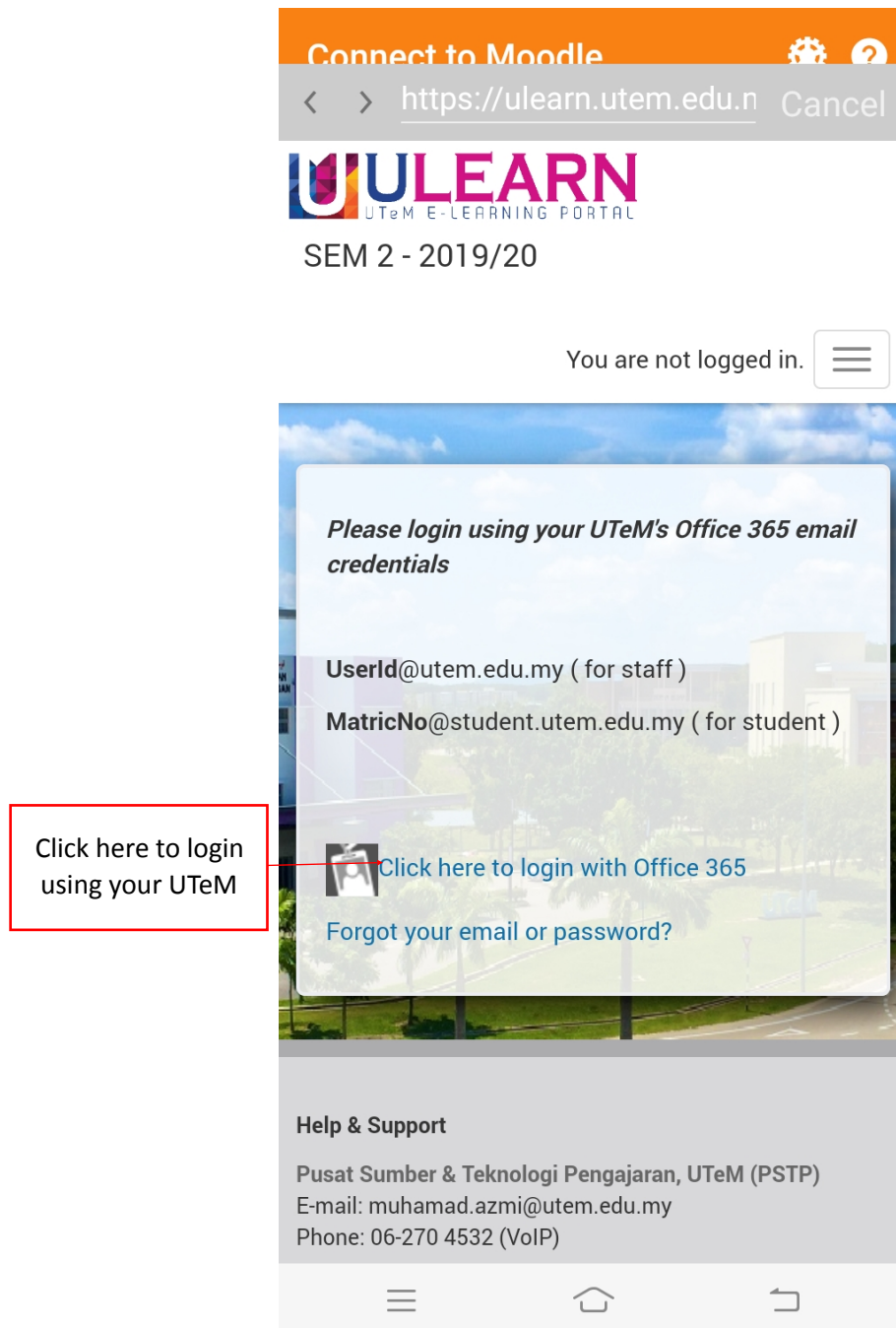

STEP 7

Once successful, you can finally access the U-Learn by using Moodle Mobile on your smart devices. Moodle for Desktop also available for MacOS and Windows Operating System.

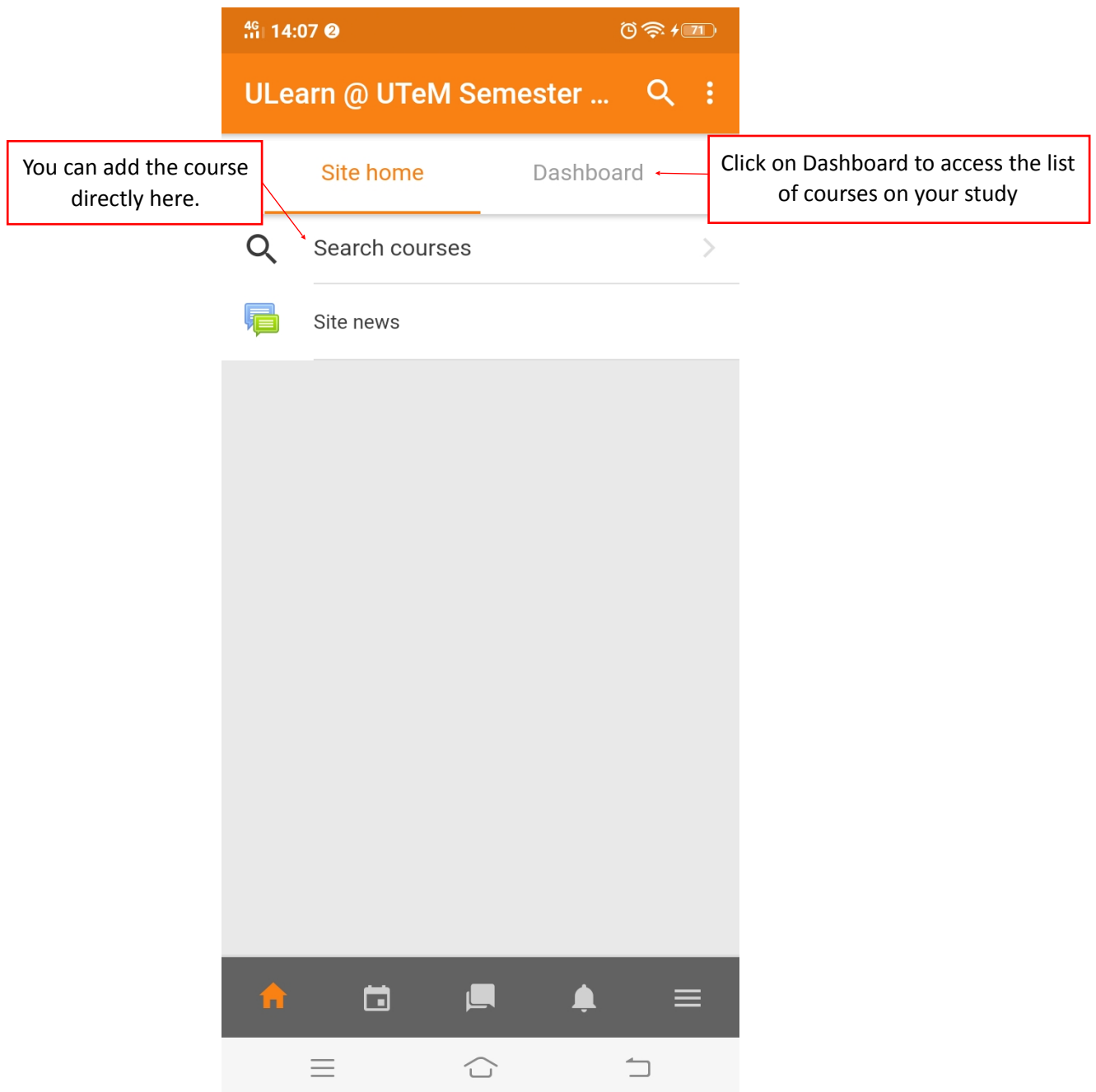



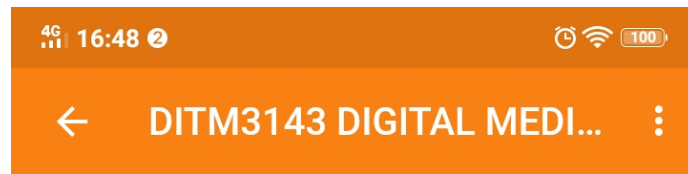

Contents Participants Grades >

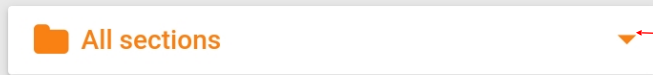

For easier access to the course contents, you can click here.

General



LEARNING OUTCOMES

You can scroll down the application to access more content.

Upon completing this course, students will be able to:

1. Explain the concepts, techniques and basic desktop publishing production process and graphic design theory. **(C2)**

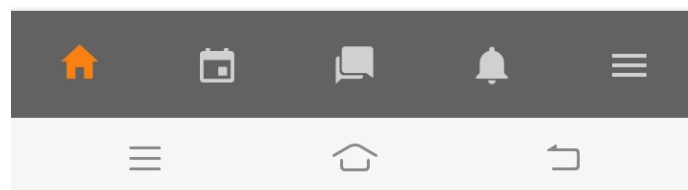

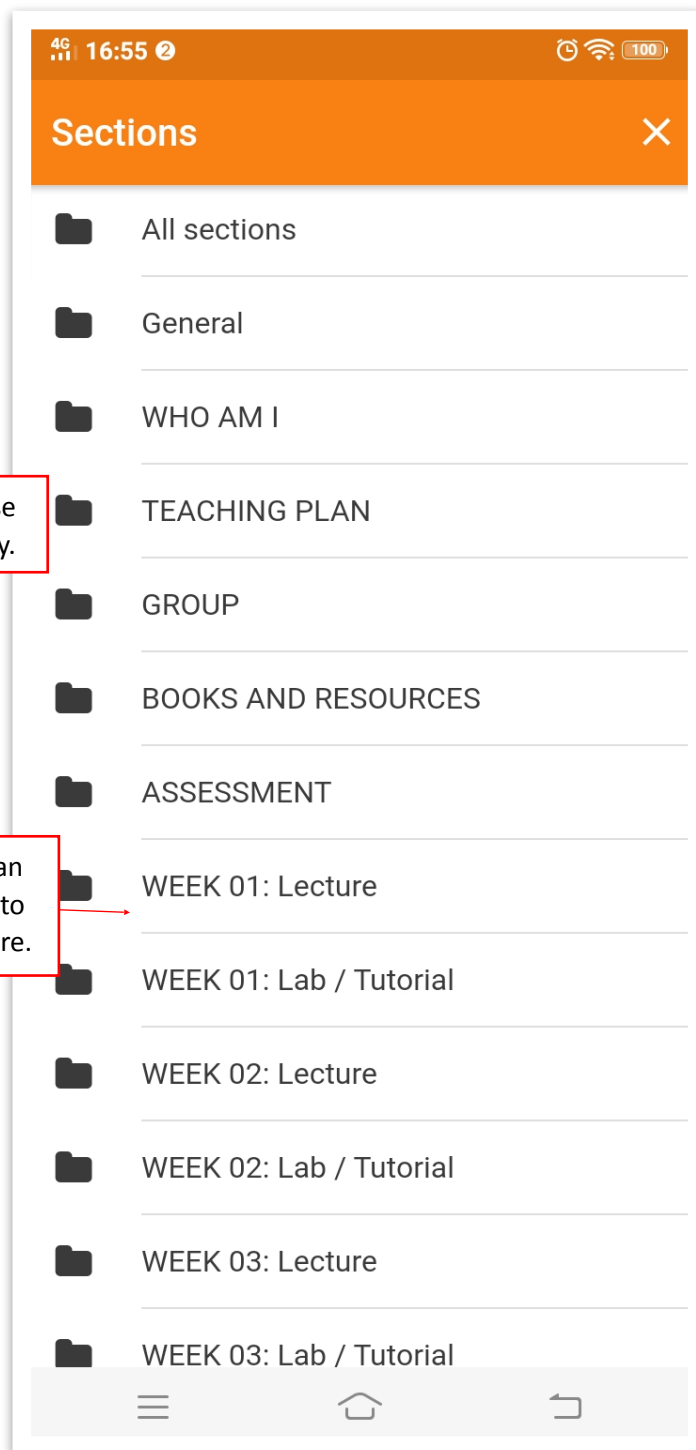

Here you can choose the sections directly.

For example, you can click here to access to your first week lecture.

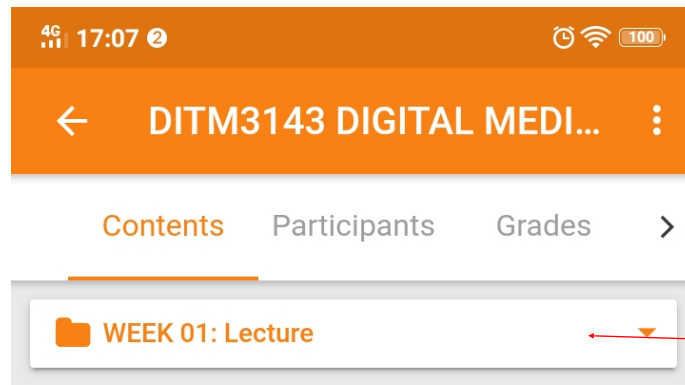

Here you can see the directory change based on the section that you choose.

LEARNING OUTCOME

By the end of this lesson the student will be able to:

- a) Explain the definition of Graphic Design
- b) Understand the History of Design
- c) Differentiate between Fine Art and Graphic Design

What is Graphic Design

Graphic design is the process of visual communication and problem-solving through the use of [typography](#), [photography](#), and [illustration](#). The field is considered a subset of [visual communication](#) and [communication design](#), but sometimes the term "graphic [design](#)" is used synonymously. Graphic designers create

Scroll down to access more content for this topic

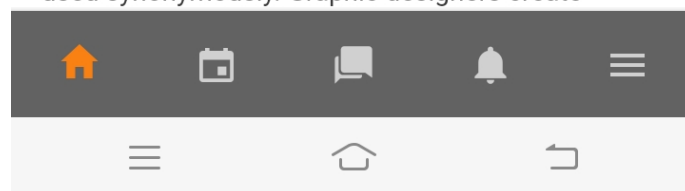

Week 01 Video



This is a simple explanation of what is Graphic Design is. Watch this video until the end to understand the fundamental of it.



Week 01 Lecture Note

This is your lecture note for Week 01. It covers topics of:

1. What is Graphic Design (History, Visual Art,

[Show more...](#)

